

**TTBC** TERMINAL CABO-BARRAMENTO DE COBRE

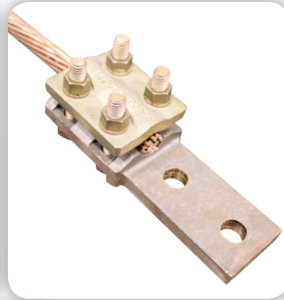

**Finalidade:** Terminação cabo-barramento para cabos de cobre.

**Características:** Conexão por aperto. Alta condutividade elétrica. Sapata com dois ou quatro furos padrão NEMA. Possui ressaltos que travam a cabeça dos parafusos.

**Aplicação:** Redes de distribuição de energia elétrica e subestação.

**Material:** Terminal em bronze, acessórios em liga de cobre.

**Ferramentas de Aplicação:** Chave estrela ou fixa.

**Observação:** Recomenda-se o uso do composto anti-óxido **INTELTROX-Cu**.

**Normas de Referência:**

**NBR-5370**



Figura 01



Figura 02

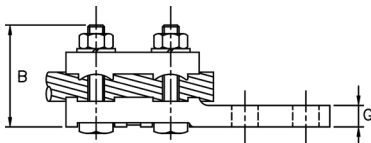
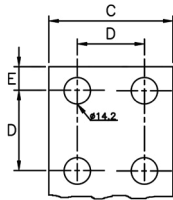
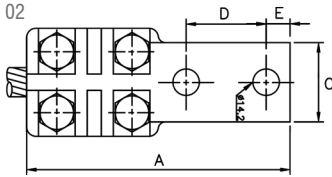

Código INTELLI	Condutores				Parafuso	Dimensões (mm)						Figura
	Mínimo		Máximo			A	B	C	D	E	G	
	mm <sup>2</sup>	AWG/MCM	mm <sup>2</sup>	AWG/MCM								
TTBC 4-1/0-2N	25	4	50	1/0	M10	140,0	45,0	32,0	44,5	16,0	10,0	2
TTBC 2/0-4/0-2N	70	2/0	120	4/0	M10	147,0	55,0	32,0	44,5	16,0	10,0	2
TTBC 250-500-2N	120	250	240	500	M10	150,0	55,0	43,0	44,5	16,0	10,0	2
TTBC 250-500-4N	120	250	240	500	M10	148,0	60,0	76,0	44,5	16,0	10,0	1
TTBC 500-800-2N	240	500	400	800	M10	157,0	60,0	44,0	44,5	16,0	12,0	2
TTBC 500-800-4N	240	500	400	800	M10	153,0	60,0	76,0	44,5	16,0	14,0	1
TTBC 750-1000-2N	400	750	500	1000	M12	165,0	60,0	53,0	44,5	16,0	13,0	2
TTBC 750-1000-4N	400	750	500	1000	M12	160,0	60,0	76,0	44,5	16,0	13,0	1
TTBC 1000-1500-4N	500	1000	630	1500	M12	170,0	75,0	78,0	44,5	16,0	14,0	1
TTBC 1500-2000-4N	630	1500	1000	2000	M12	174,0	75,0	79,0	44,5	16,0	18,0	1